

765nm/6W Multi-Mode Pigtailed Laser

Dimensions

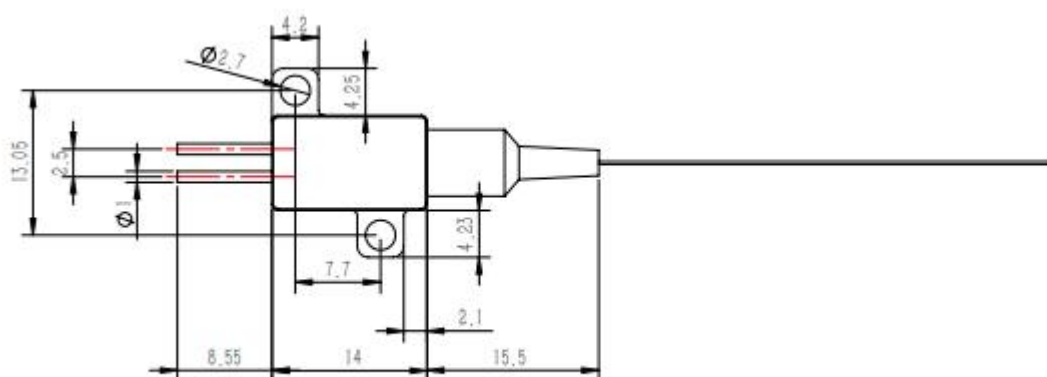
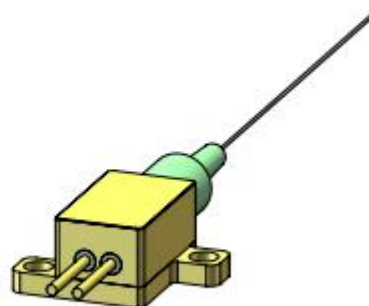
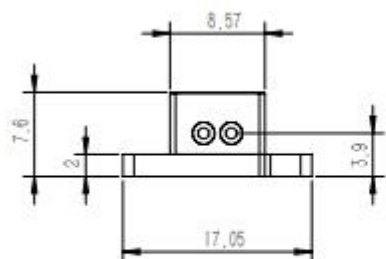

Features:

- High output power
- Excellent beam quality
- High reliability

Applications:

- Laser display
- Laser engraving
- Laser illumination

765nm/6W Multi-Mode Pigtailed Laser

Specifications

Parameters	Min.	Typical	Max.	Test Conditions
Optical Properties				
Center Wavelength	760nm	765nm	768nm	At Po = 6W & Tcase = 25°C
Output Power (Pop)		6W	7W	At Tcase = 25°C, Iop = 9A
Operating Temperature (Tcase)	-10°C	25°C	45°C	Using a base with good heat dissipation.
Electrical Properties				
Threshold Current (Ith)		0.8A		
Operating Current (Iop)		7.8A	9A	At Po = 7W & Tcase = 25°C
Operating Voltage (Vop)		1.8 V	2.3V	At Po = 7W & Tcase = 25°C
Reverse Breakdown Voltage (VR)		0.8V		
Fiber Type				
Numerical Aperture (NA)		0.22		
Fiber Model	200/220			Customizable
Fiber Length	>1.0 m			Customizable
Ferrule Specifications	0.9 black loose tube			Customizable
Output Connector	Bare fiber or FC/APC			Customizable
Storage Conditions				
Storage Humidity	5% ~ 85% RH			No condensation
Storage Temperature	-20 ~ 60°C			No condensation